

92-K-60 - SPEEDLINE System Data Sheet - Version V1 (24-10-23)

SPEEDLINE 92mm 'C' Stud Partition @600mm Ctrs,
with 2x Knauf 15mm Soundshield Plus each side,

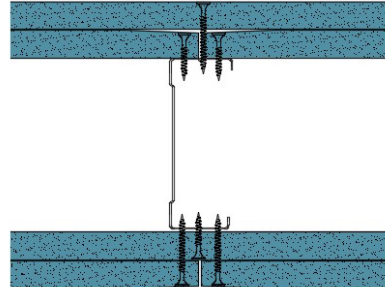

System Performance Breakdown

Fire Resistance:

BS476 Part 22:1987:

Test Ref & Date or Applied Ref & Report:

Max Height:

Thickness:

Duty Grade: BS 5234: Part 2:1992:

Sound Insulation:

120/120 Minutes (Integrity/Insulation).

BMT/FEP/F14077 - BRE Report P102396-1011B

Refer to Speedline Specification Clause

154 mm. (At Base Track, Excluding Finishes)

Severe - Annexes A-F

53 R_w dB, Date Tested or Assessed Against - 70-K-59

Test Code:
H17434AA
Test Date:
27/06/2011

Freq. Hz	R dB
50	25.1
63	17.6
80	14.3
100	27.5
125	32.7
160	36.3
200	41.4
250	44.4
315	46.0
400	49.8
500	53.1
630	54.6
800	58.7
1 000	60.5
1 250	63.4
1 600	66.3
2 000	65.4
2 500	54.0
3 150	50.9
4 000	54.3
5 000	57.6
6 300	
8 000	
10 000	

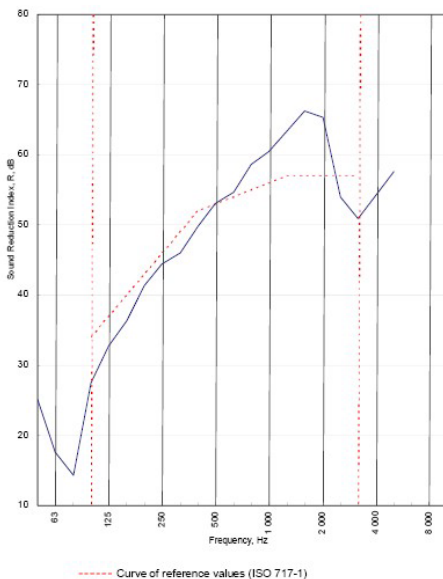



Rating according to BS EN ISO 717-1:1997 **R_w (C;Ctr) = 53 (-3;-8) dB**
Max dev. 6.5 dB at 100 Hz

C_{50-500} = -8 dB	C_{50-500} = -7 dB	$C_{100-500}$ = -2 dB
$C_{125-500}$ = -19 dB	$C_{125-500}$ = -19 dB	$C_{125-500}$ = -8 dB

TESTED AT ONE OF THE UKAS ACCREDITED LABORATORIES BELOW

B.T.C (H-Ref on Graph) 

B.R.E 

AIRO 

S.R.L 

Customer: Metsec plc Hepsec Division

BTC 17434A: Page 8 of 10



SPEEDLINE Drywall Systems, Adsetts House, 16 Europa View, Sheffield Business Park, Sheffield, S9 1XH.

Tel: 0114 231 8030.

Email: enquiries@speedlinedrywall.co.uk

(As per the requirements set out in ISO/IEC 17025:2017 regarding test data the results stated have been carried out by voestalpine Metsec plc as part of the contract to supply Speedline Metal Sections to SIG Plc)